

MOK

SENSIO

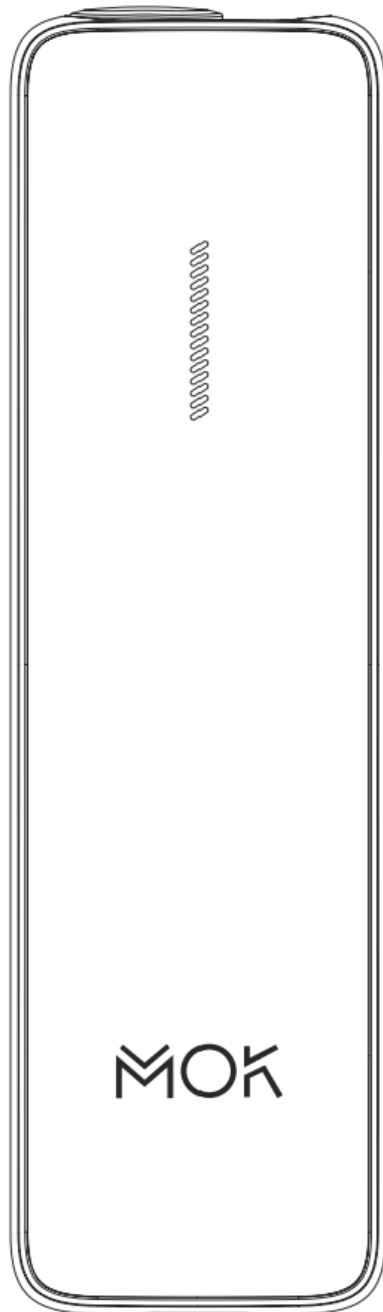

USER MANUAL

# MOK SENSIO

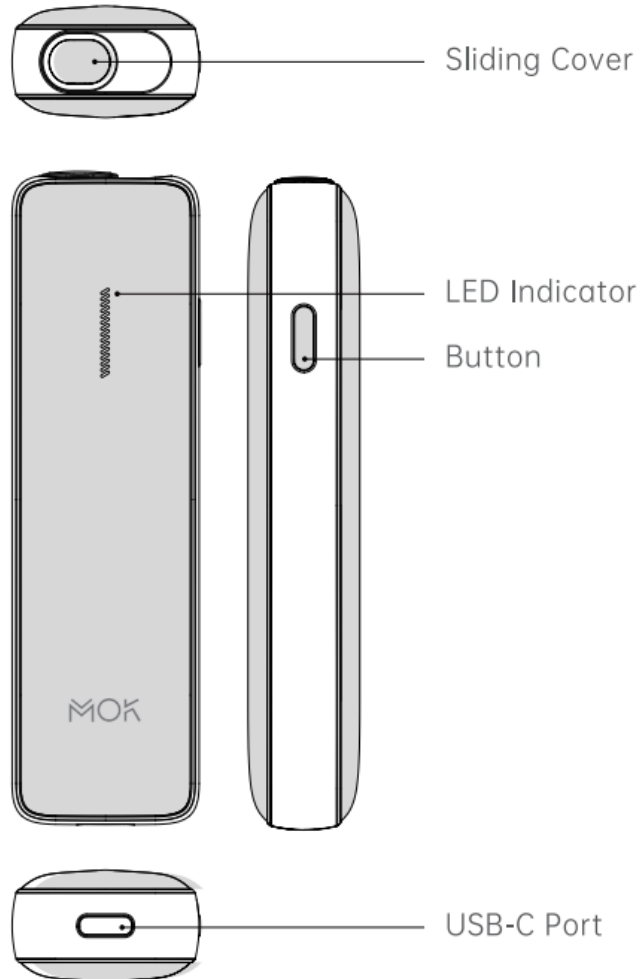

## PACKAGING CONTENTS

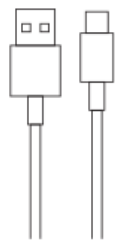

USB-C Cable

## CAUTION

- Minors and/or persons under the legal age, pregnant women, nursing mothers, and people with heart disease, high blood pressure, diabetes, asthma, epilepsy, or people who are allergic to nicotine should never use this device under any circumstances.
- DO NOT use this device in the presence of flammable materials, liquids and gases, such as at gas stations, chemical plants and in other environments exposed to flammable materials. Keep this device away from children to avoid bodily harm.
- This device is only suitable for SENTIC sticks. DO NOT use with combustible cigarettes or other non-compatible consumables as this may cause damage to the device or other hazards resulting from improper use.
- This device is not waterproof. DO NOT wash or place it in a wet environment. Keep the sliding cover CLOSED after use to minimize any potential risk of exposure to liquids.
- If the temperature in hand is abnormally high during use, please stop using the device immediately and close its sliding cover. Ensure the device is cool before repeating use.
- DO NOT overcharge the device. Unplug the power cable once fully charged.
- After the heating session, the stick may still be very hot. Handle with care to avoid burns.

## INSTRUCTIONS FOR FIRST USE

### I-1. Charge the device

- Connect the USB-C charging cable to the power adapter and to the USB-C port of the device to charge the device.
- The LED light bar in front of the device will flash during charging and will turn off once the device is fully charged.

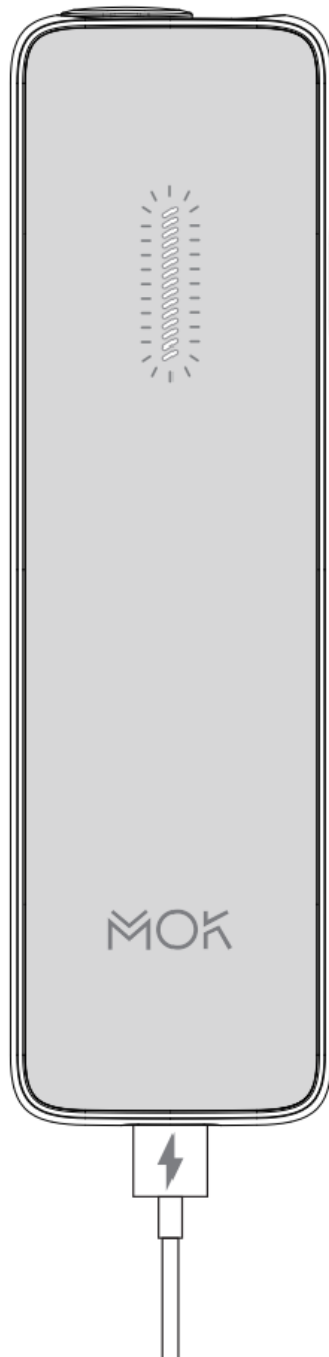

## I-2. Unlock the device

- If the LED does not turn on when pressing the button, the device is in LOCKED mode (child lock).
- Click the button 5 times in rapid succession to unlock the device. The device will respond with a long haptic vibration feedback.

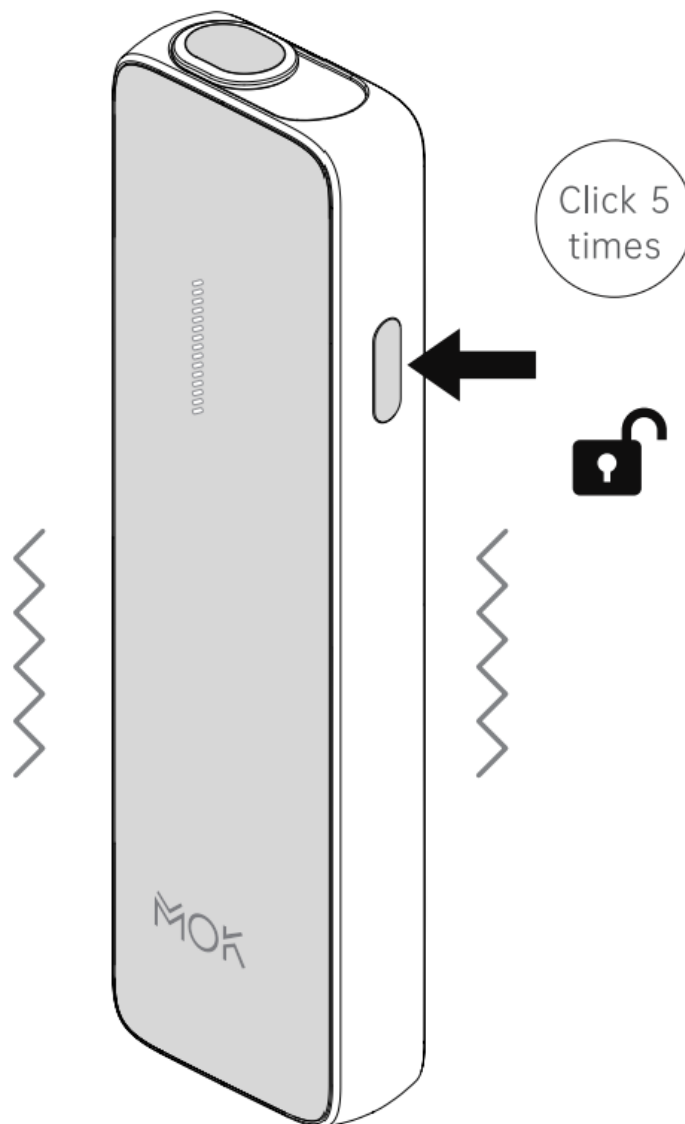

### I-3. Lock the device

- The device is in UNLOCKED mode without heating.  
Click the side button 5 times in rapid succession to lock the device. The device will respond with a long haptic vibration feedback indicating it is now locked.
- In LOCKED mode, heating or any other function is unavailable.
- Secure the device in locked mode for safe storage if you will not be using it for extended periods of time.

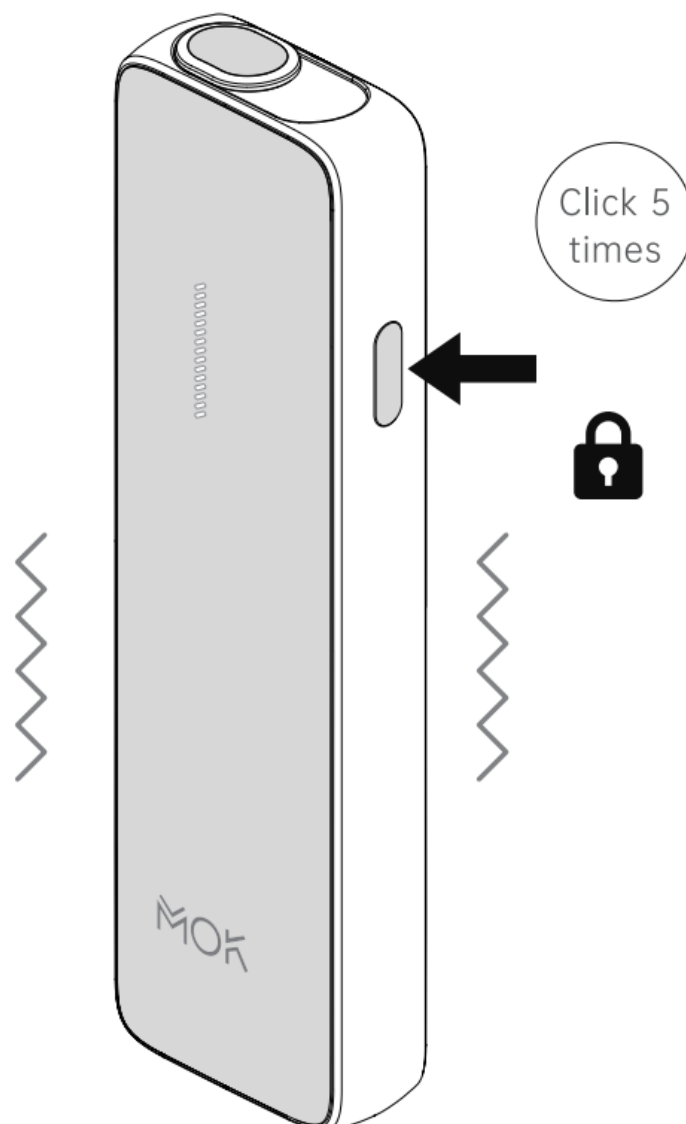

# HOW TO USE YOUR DEVICE

## 01. Open the sliding cover

- Make sure the device is unlocked and is sufficiently charged.
- Open the sliding cover on top to wake up (activate) the device. The LED will light up and the device will vibrate to indicate it is turned on.
- The LED length indicates the remaining battery level.
- After a period of inactivity, the device will enter sleep mode.

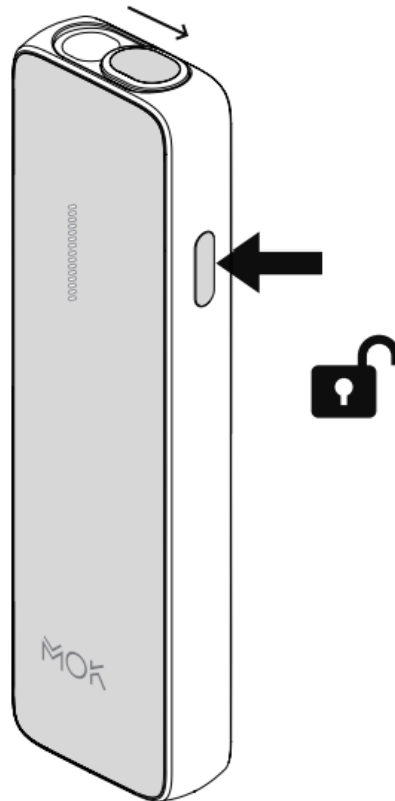

75%-100%



50%-75%



25%-50%



<25%



Low power

## 02. Auto-heating

- Gently insert a stick from the top and align the upper indicator line printed on the stick with the rim of the device's stick insertion chamber.
- The device will automatically start preheating when it is awake. The LED will turn on and pulse and the device will vibrate. If the device is asleep, press and hold the side button for 2 seconds to manually start preheating.
- When preheating is completed (within approximately 18 seconds), the device will vibrate once and the LED will stay on. The device is now ready for use.

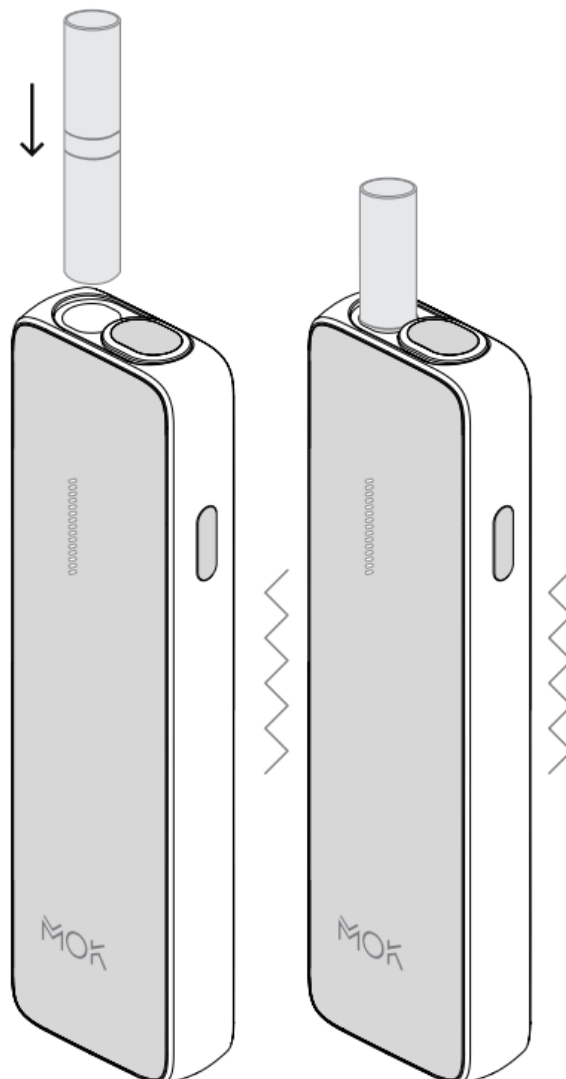



### 03. Enjoy the session

- The duration of each heating session is approximately 5 minutes (including preheating time) or 14 puffs.
- The LED will pulse and the device will vibrate to indicate 30 seconds or 2 puffs remain in the session.
- The LED will turn off and the device will vibrate once the heating session is finished.
- Pressing and holding the button for 2 seconds or pulling out the stick during a heating session will immediately interrupt the heating process and the session.

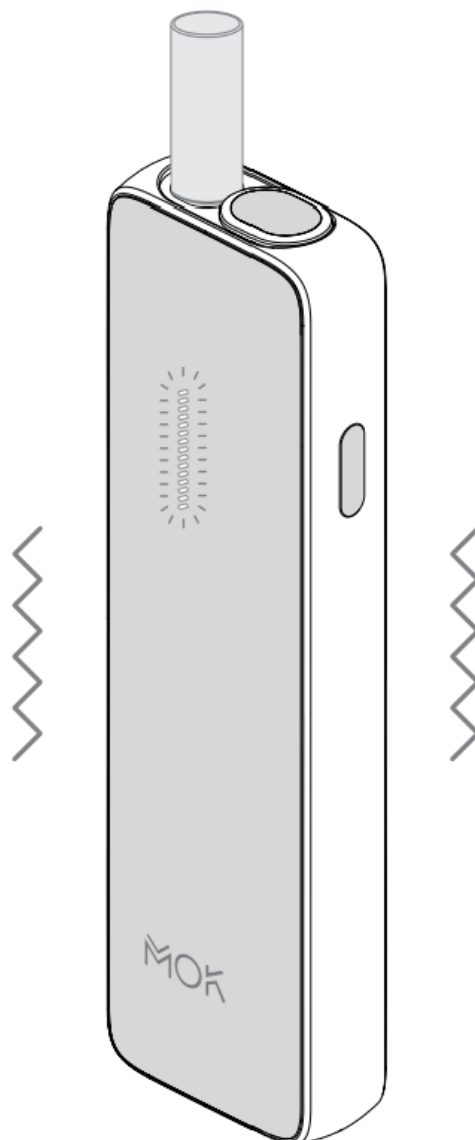

## 04. Remove the stick

- After the heating phase is complete, remove the stick.
- Be careful when removing the stick as it may be hot.
- Please dispose of the used stick in a trash bin or ashtray.

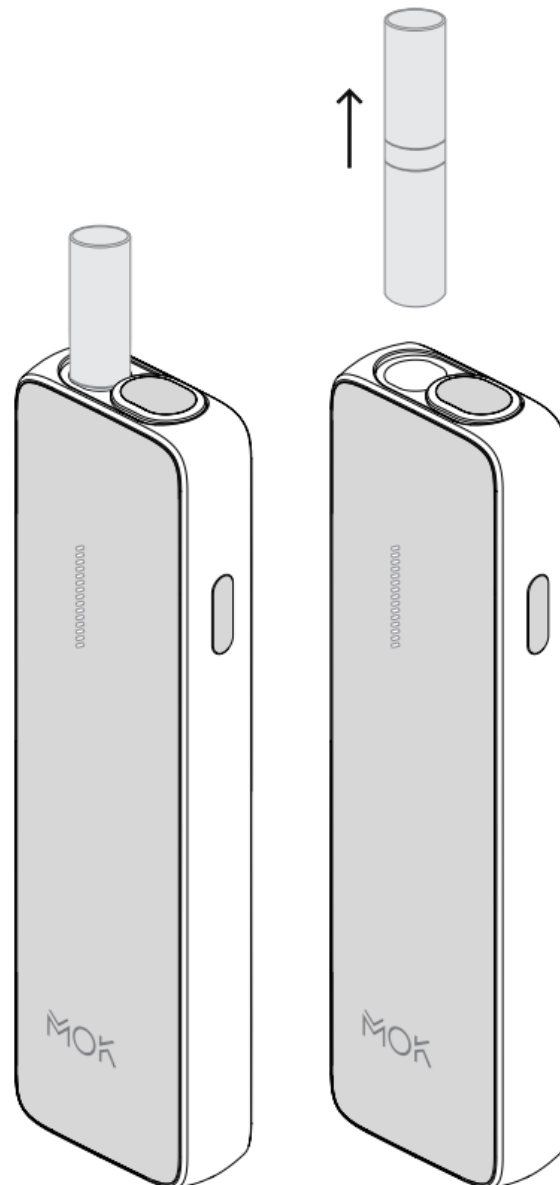

## 05. View the battery level

- Press the side button to check the remaining battery level. The LED light length indicates the current battery level.

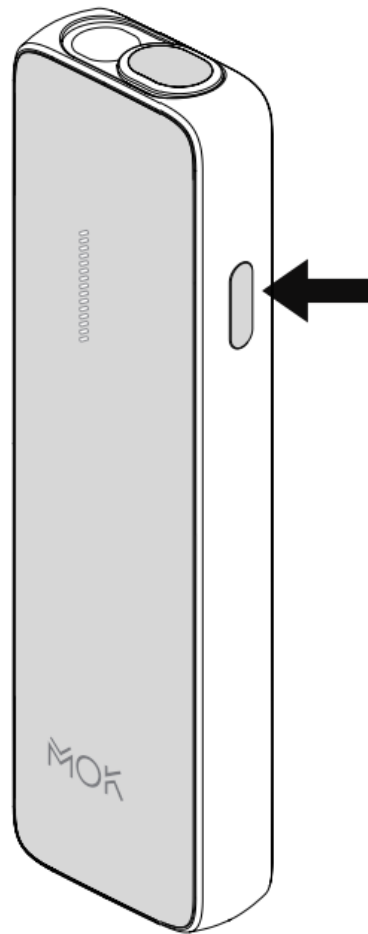

75%-100%



50%-75%



25%-50%



<25%



Low power

## 06. Close the sliding cover

- Please close the sliding cover after each use. The device will be inactive. If the sliding cover is not closed for a period of time after use, the device enters sleep mode and the auto-heating feature will be disabled.

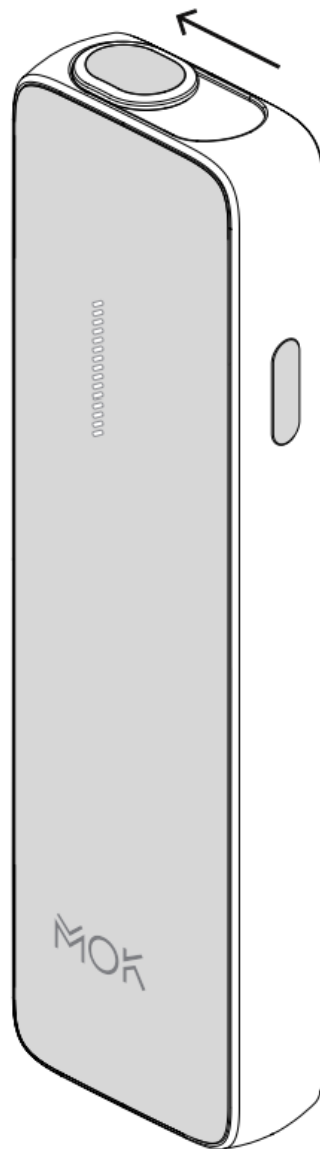

## 07. Charging

- Connect the charging cable to the USB-C port at the bottom of the device.
- LED length during charging indicates current charging level.
- Once fully charged, the LED will turn off.  
Remove the charging cable once the device is fully charged.

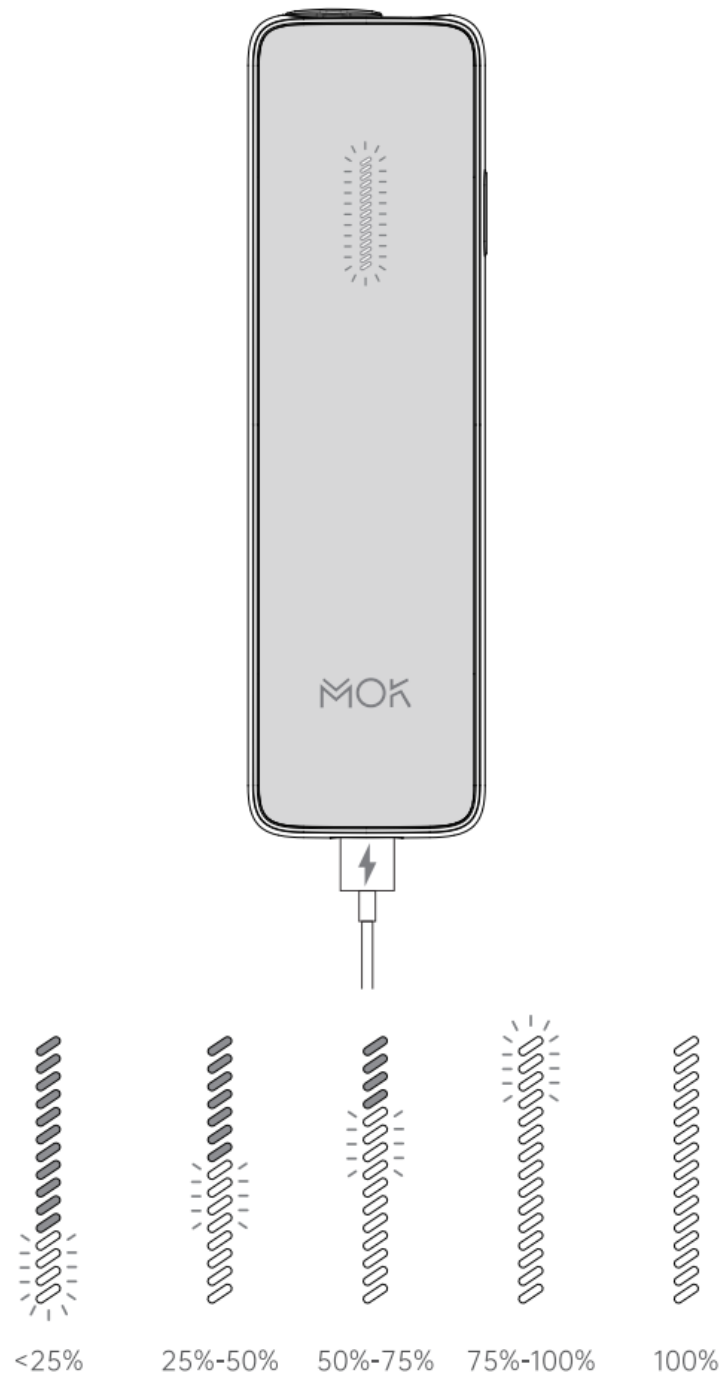

## 08. Troubleshooting

- In the event of a malfunction, the device will stop heating, the LED bar will flash repeatedly, and then the device will vibrate, indicating that the error mode is active:

- LED flashes 8 times:  
The battery voltage is too low to work.



- LED flashes 5 times,  
vibrates 1 time:  
Abnormal temperature of the device.



- LED flashes 3 times,  
vibrates 1 time:  
Abnormal temperature of the heating component.

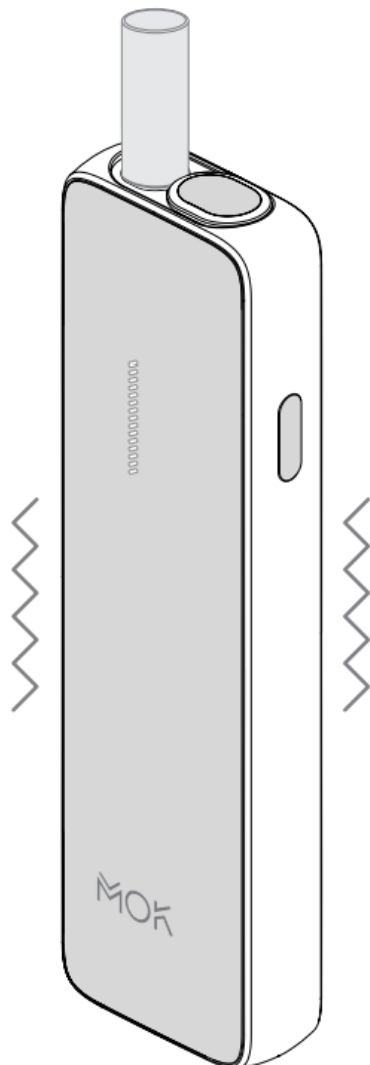

### 13. Device specifications

Model Name	MOK SENSIO
Battery Type	Lithium ion rechargeable
Battery Capacity	3.85V/2000mAh
Input	5V/2.0A
Session Duration	Approximately 5 minutes (including preheating) or 14 puffs
Fully-charged Capacity	Approximately 20 sessions

MOK  
SENSIO